

FINALIZE THE INSTALLATION FOR

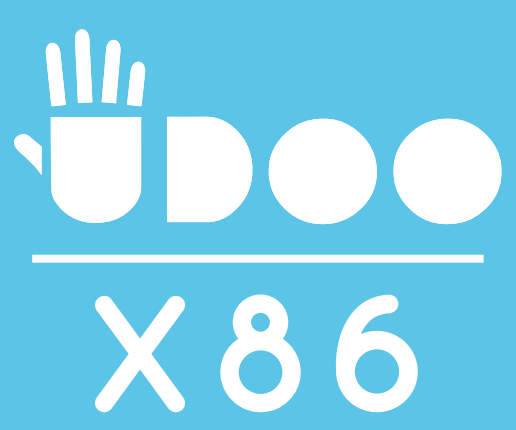

WINDOWS AND UBUNTU

1 Where can you install the OS?

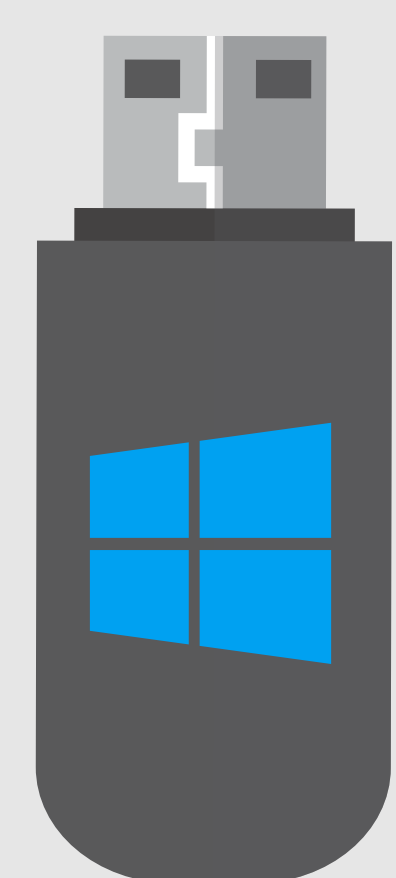

Windows OS



Ubuntu OS

Chose where you want to install the Operating System on your board. You have several possibilities:

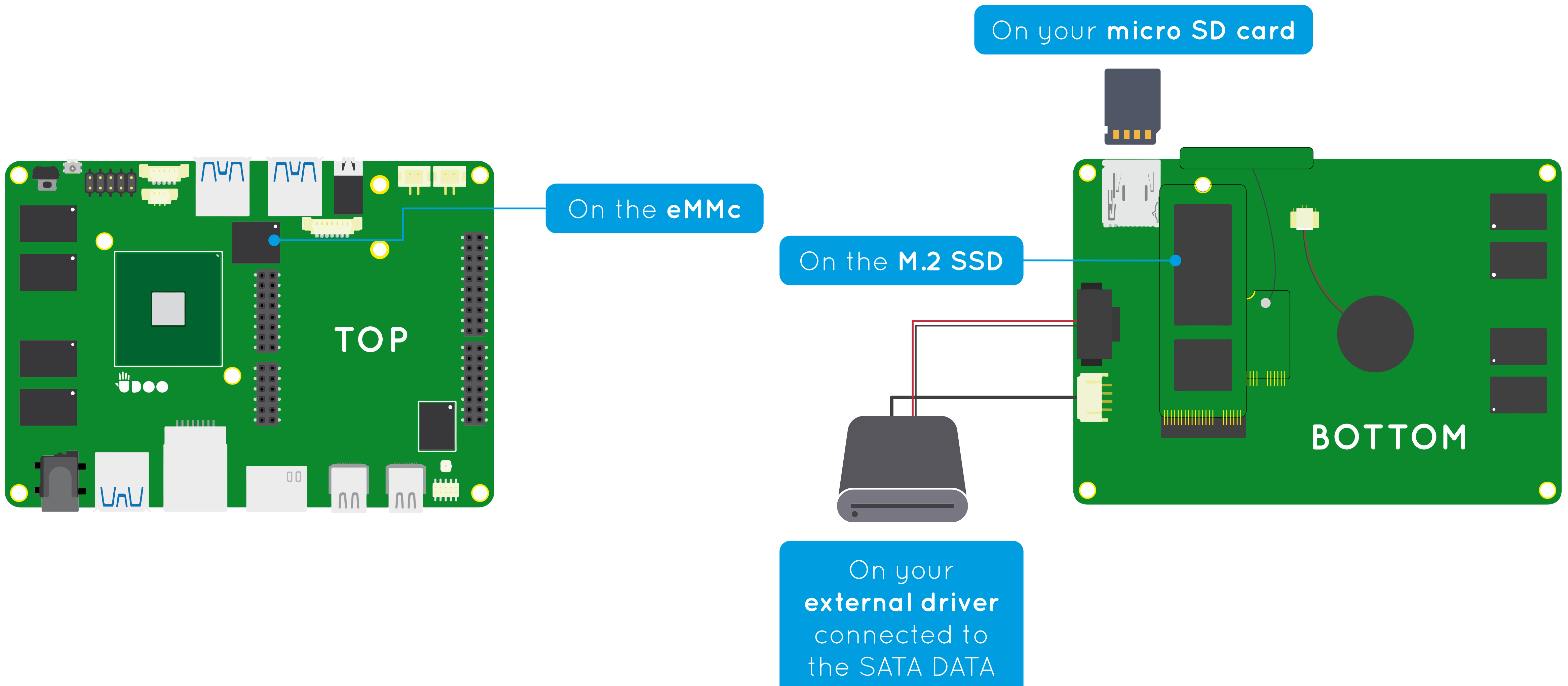

2 Power up the board

A Power up the board

B Keep pressing escape
Right after your monitor has turned on

C Enter into the BIOS
The bios will automatically launch itself

D Boot manager

Click on «boot manager»

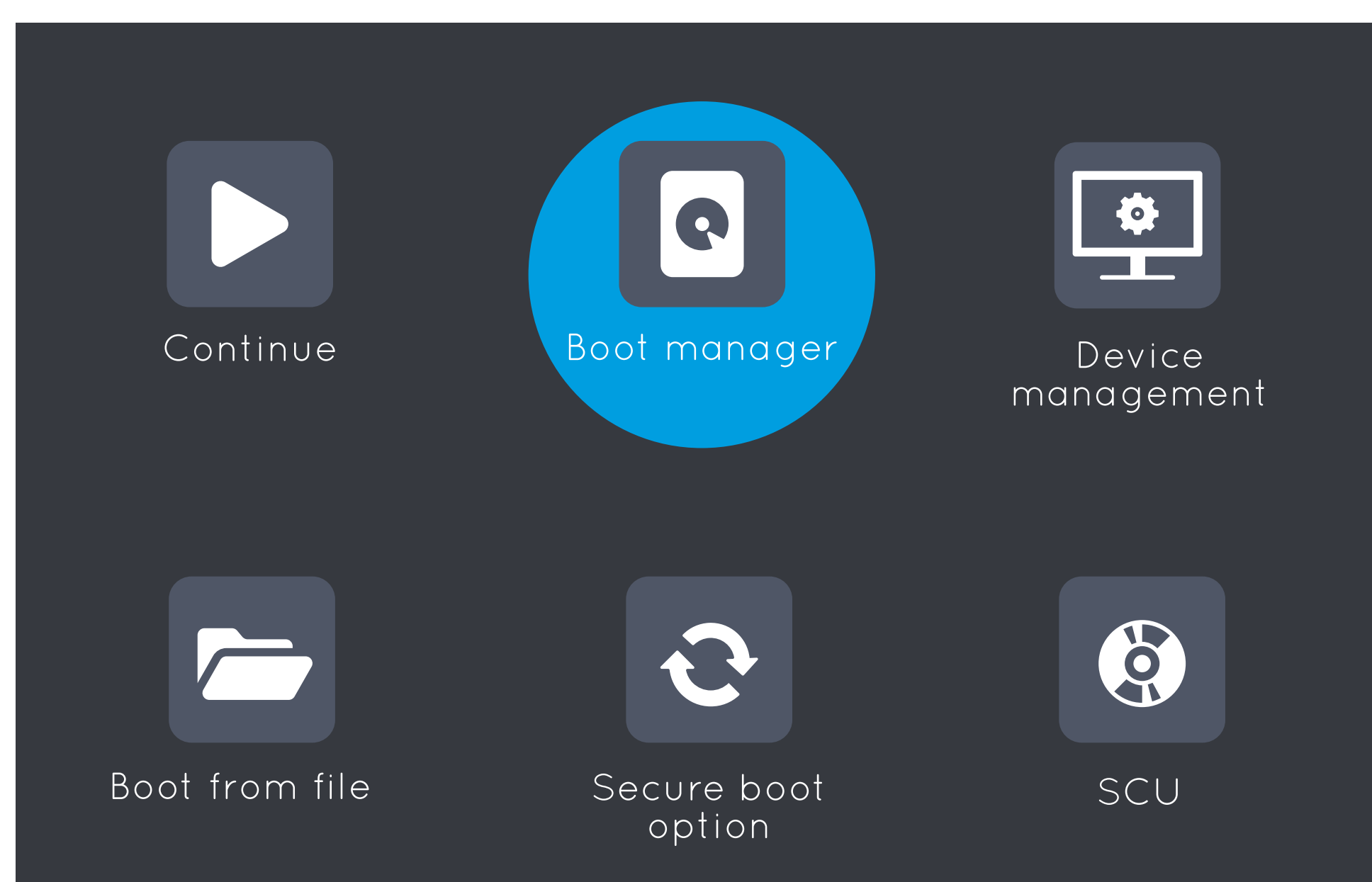

Select the drive that you have insert into the board previously

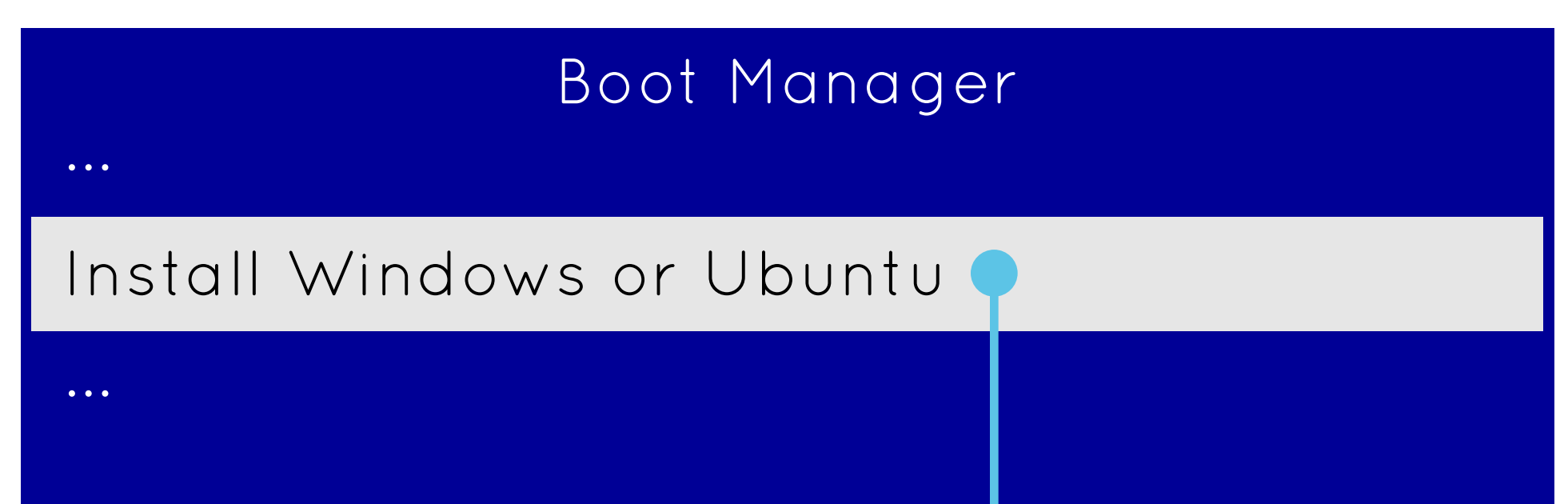
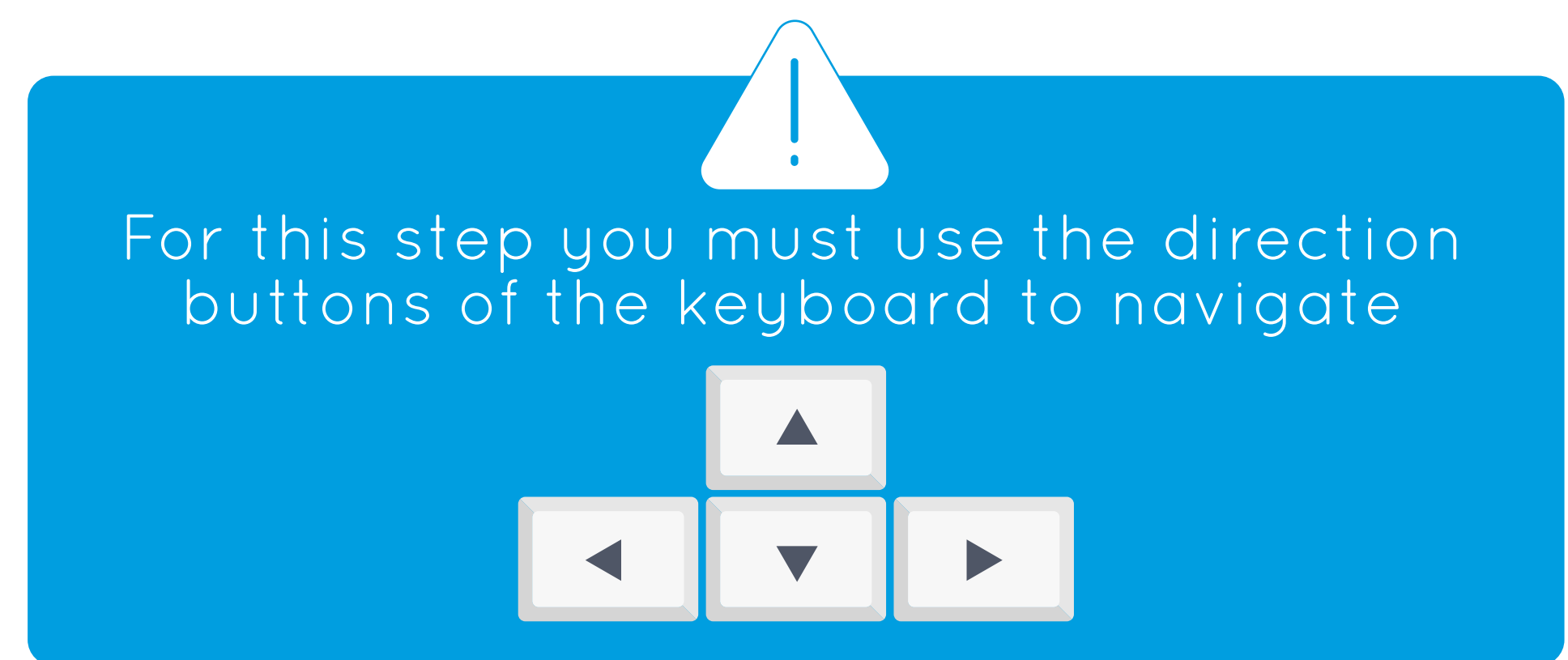
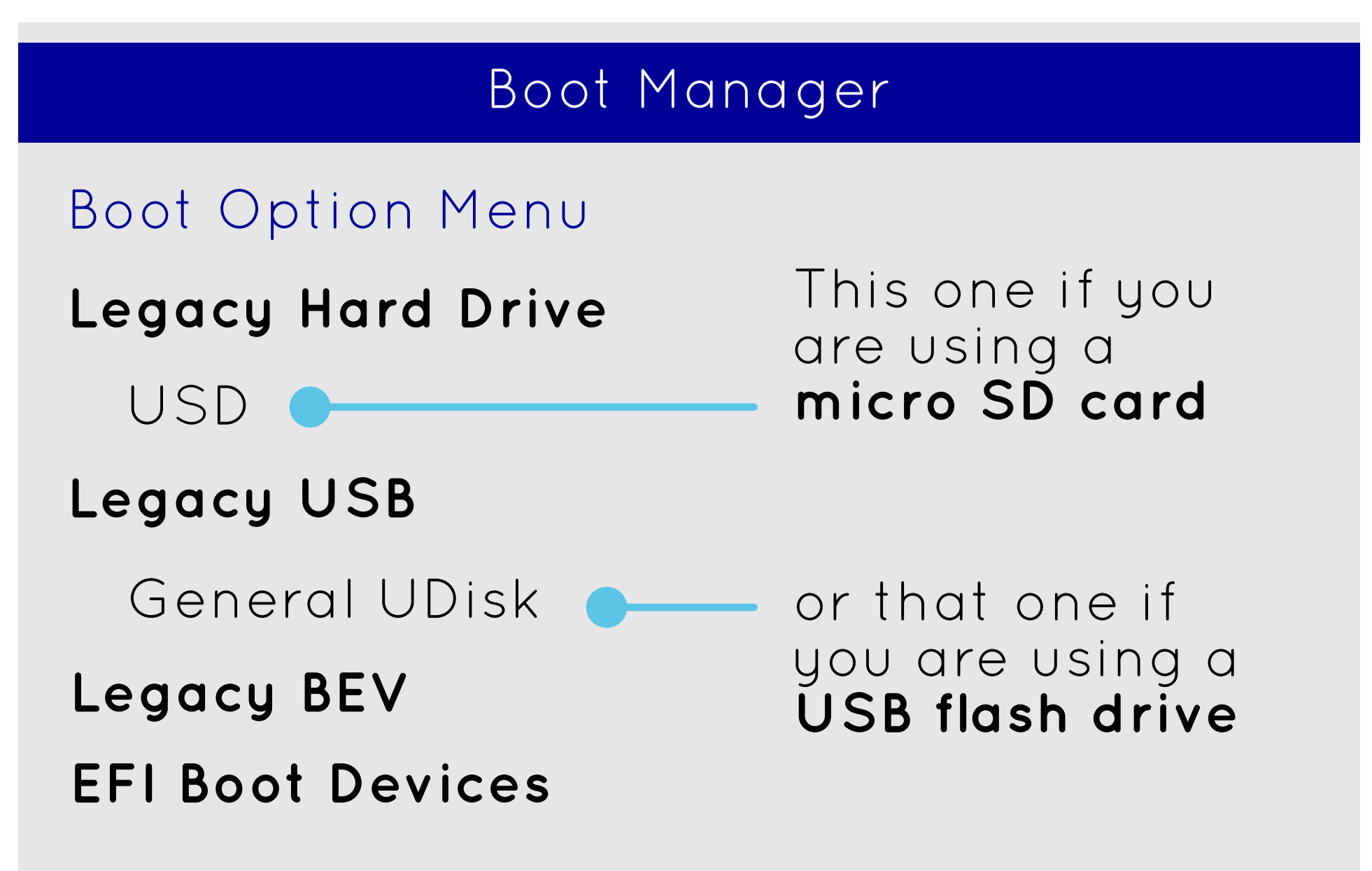

3 Install the OS on your X86

Windows

A Select the device on which you want to install Windows 10 on the board

You have the choice between:

- eMMC
- SATA SSD/HDD
- M.2 SSD

MIN 20GB

B Follow the instructions of installation (date, hour, country, ...)

C Wait for the installation to complete and restart the board

Ubuntu

A Follow the instructions of installation (date, hour, country, ...)

B Select the type of installation. You have the choice between two possibilities:

- Default option
 >> Erase disk and install Ubuntu
- If you feel more like an expert
 >> Something else

In that case you will have to do the **partitioning of Ubuntu** by yourself and **choose the device** on which you want to install Ubuntu

You have the choice between:

- eMMC
- SATA SSD/HDD
- M.2 SSD
- Micro SD card

MIN 8GB

C Wait for the installation to complete and restart the board

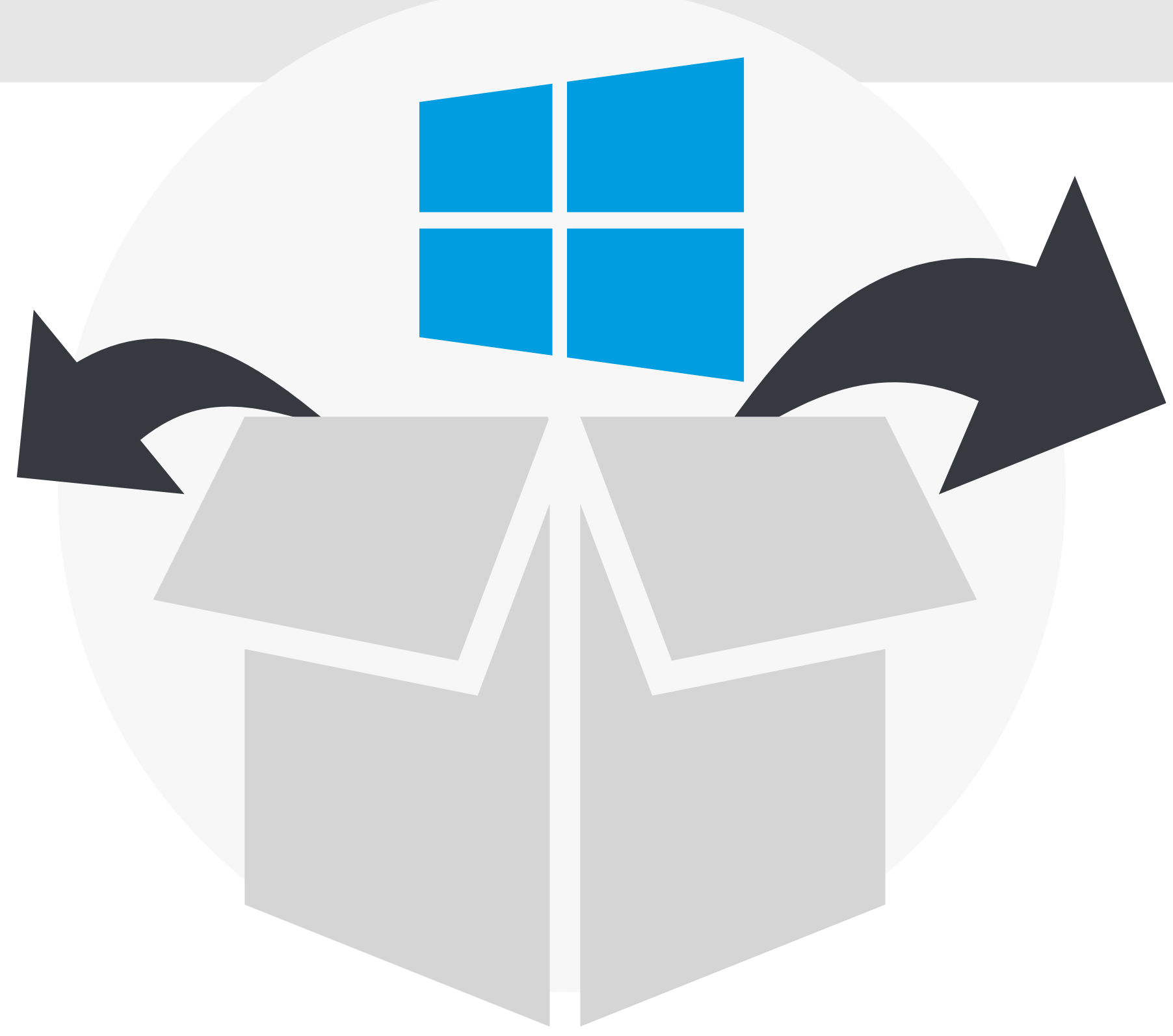

Your UDOO X86 is now ready to use!